

**KALAMAZOO PEOPLE'S
FOOD CO-OP**
KALAMAZOO, MI



P.J. Hoffman 800-615-1533 x62128
c/o UNFI 763-717-7466 fax
PO Box 120330
St. Paul, MN 55112 PHoffman@unfi.com

NOTES:

NOT TO BE USED IN CONSTRUCTION

This drawing is submitted for design intent only. It is not to be used in lieu of necessary architectural and engineering plans nor should it be used or filed for construction permits.

Dimensions are based on information provided by others and should be field-verified.

This drawing is the sole property of UNFI Store Development Services and unauthorized reuse or reproduction is prohibited.

No.	Date	Revision

PRELIMINARY
SKETCHES



Date: 1/18/2010
Drawn By: PJH
Scale: 3/16" = 1'-0"

F1

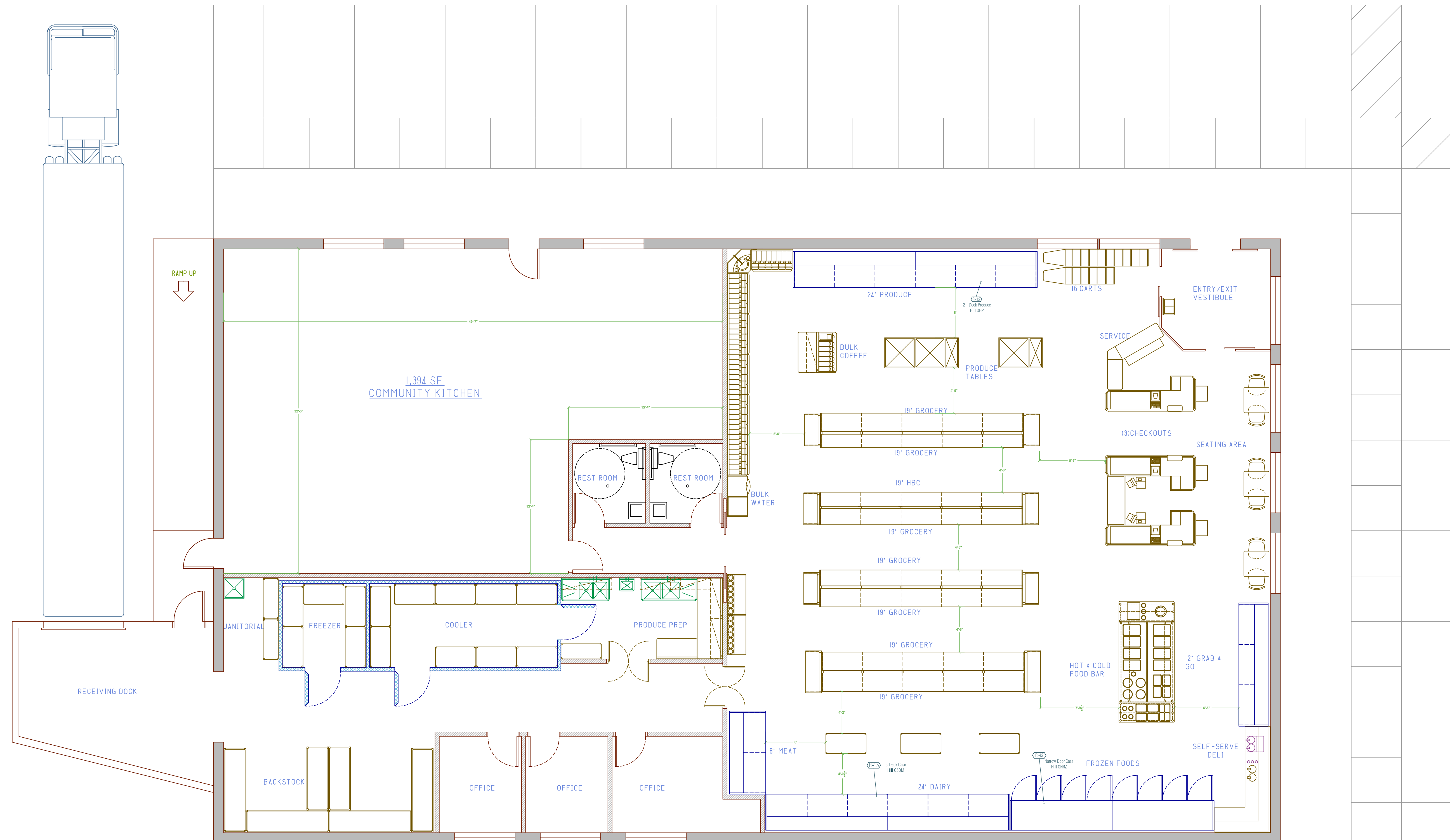

SCHEME F

AREAS:

- Building Footprint: 6,360 SF
- Net Interior Space: 6,028 SF
- Coop Occupied Area: 4,400 SF
- Retail Area: 3,132 SF (70%)
- Community Kitchen: 1,394 SF
- Other Areas: 228 SF